

- NOTES:**

1. ALL WORK IN ACCORDANCE WITH THE RELEVANT NATIONAL STANDARDS AND SPECIFICATIONS, THE CURRENT EDITION SHALL BE USED.
2. WHERE REFERENCE IS MADE TO THE SOUTH AFRICAN STANDARD SPECIFICATIONS, THE CURRENT EDITION SHALL BE USED.
3. REFERENCE TO ARCHITECT'S LAYOUTS FOR SETTING OUT INFORMATION.
4. ALL DIMENSIONS AND LEVELS TO BE CHECKED ON DISCREPANCIES TO BE REPORTED TO THE ENGINEER IMMEDIATELY.
5. ONLY WRITTEN DIMENSIONS AND LEVELS SHALL BE USED.
6. THIS DRAWING TO BE READ IN CONJUNCTION WITH THE DRAWINGS FROM THE RELEVANT DISCIPLINES ARCHITECT, CIVIL, ELECTRICAL AND MECHANICAL.
7. THE CONTRACTOR SHALL OWE THE ENGINEER AT ALL TIMES THE ADVANCE NOTICE FOR INSPECTIONS.
8. THE ENGINEER SHALL BE NOTIFIED WITHOUT DELAY SHOULD THERE BE ANY DISCREPANCY BETWEEN DRAWINGS, DETAILS AND SPECIFICATIONS.
9. FOUNDATION EVALUATIONS TO BE INSPECTED AND APPROVED BY THE ENGINEER BEFORE ANY PILING OR OTHER FOUNDATION BEFORE ANY BUILDING IS CAST.
10. REINFORCING TO BE CHECKED AND APPROVED BY THE ENGINEER BEFORE CASTING CONCRETE.
11. ALL DUCTS OR RECESSES TO BE APPROVED BY THE ENGINEER.
12. APPROVED FOR CONSTRUCTION PLANTS TO BE APPROVED BY THE ENGINEER.
13. CONCRETE STRENGTHS @ 28 DAYS:

BLINDING	15 MPa
SLABS	20 MPa
COLUMNS	25 MPa
WALLS	20 MPa
SURFACE BESS	25 MPa
BEAMS	30 MPa
14. COVERS TO STEEL REINFORCEMENT U.O.N.

FOUNDATIONS	50 mm
SLABS	30 mm
WALLS	30 mm
COLUMNS	30 mm
15. ALL SHAPE EXPOSED EDGES TO BE CHAMFERED 20 x 20mm.
16. ALL WATERPROOFING TO ARCHITECTS DETAIL.
17. SAW CUTS ARE TO BE MADE AS SHOWN IN THE DETAILS. CONCRETE IS TO BE FINISHED TO BE TORN DAMAGED BY THE CUTTING BLADE USUALLY BETWEEN 24 TO 48 HOURS AFTER CASTING.
18. ALL STEELWORK TO BE FABRICATED AND RECEIVED 180-195 °C CONFORMANCE WITH SANS 2061-5.3 A WMS.
19. ALL STEELWORK TO BE 316 STAINLESS STEEL.
20. A COMPLETE SET OF SHOP DRAWINGS SHALL BE SUBMITTED TO THE ENGINEER FOR APPROVAL BEFORE FABRICATING COMPONENTS.
21. ALL WELDS TO BE CONTINUOUS FILET WELDS IN ACCORDANCE WITH SANS 5001 AND SANS 5002 STANDARDS.

REV	DATE	DRAWN	CHECKED	ISSUED FOR INFORMATION	DESCRIPTION
00	2023-03-18	LM	KT		



DEAN COLLEGE
HTS WELKOM TECHNICAL HIGH SCHOOL
FREE STATE

TYPICAL DETAILS (SHEET 1)

	RESPONSIBLE PERSON	DATE
DESIGNED	MG	2023-03-17
DRAWN	LM	2023-03-17
CHECKED	KT	2023-03-18
APPROVED	MAN (GO-ENDER (PR. ENG. 20080241)	2023-03-18
SCALE	AS SHOWN	SHEET SIZE
PROJECT NUMBER	DRAWING NUMBER	STATUS
		REVISION
		NO

SAB1777-WTHS-161-P-00

DRAWING STATUS CODES:

R = REPORT	T = TENDER	C = CONSTRUCTION
D = DRAFT	P = PRELIMINARY	A = AS BUILT

THIS DRAWING TO BE READ IN CONJUNCTION WITH ARCHITECTS LAYOUTS

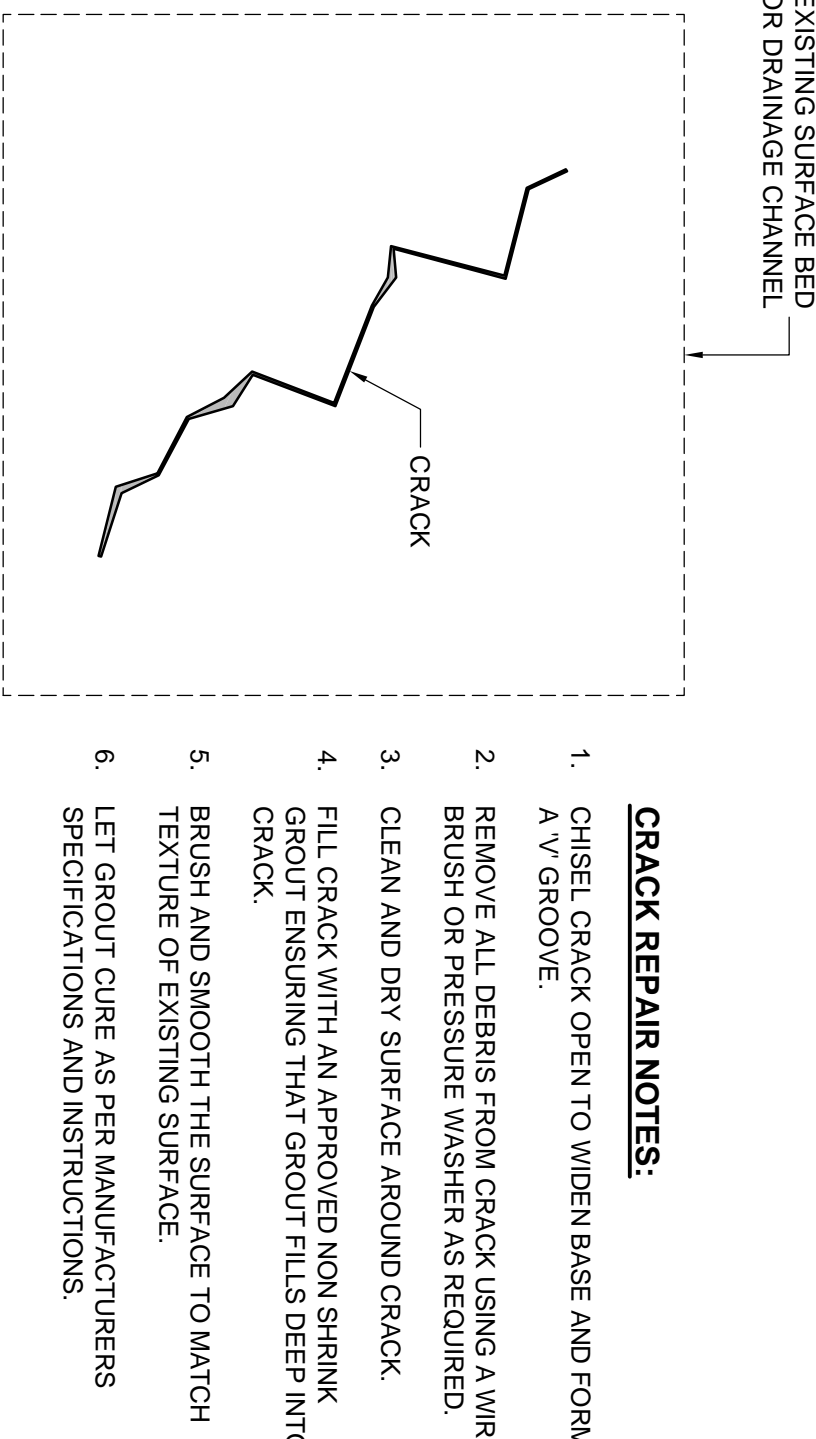

TYPICAL CRACK REPAIR DETAIL
SURFACE BED OR DRAIN CHANNEL

SCALE 1:10

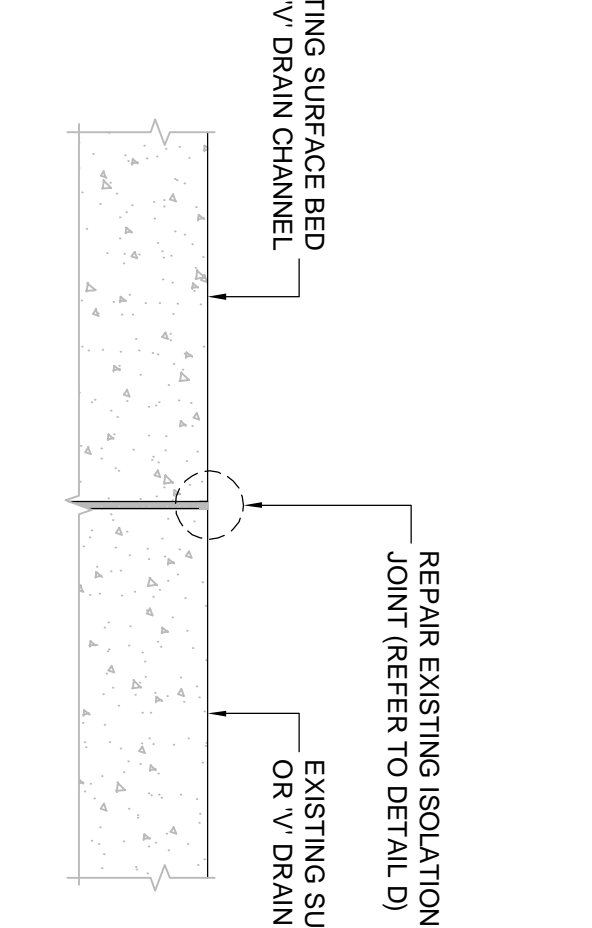

TYPICAL EXPANSION JOINT REPAIR DETAIL
SURFACE BED OR DRAINAGE CHANNEL

SCALE 1:10

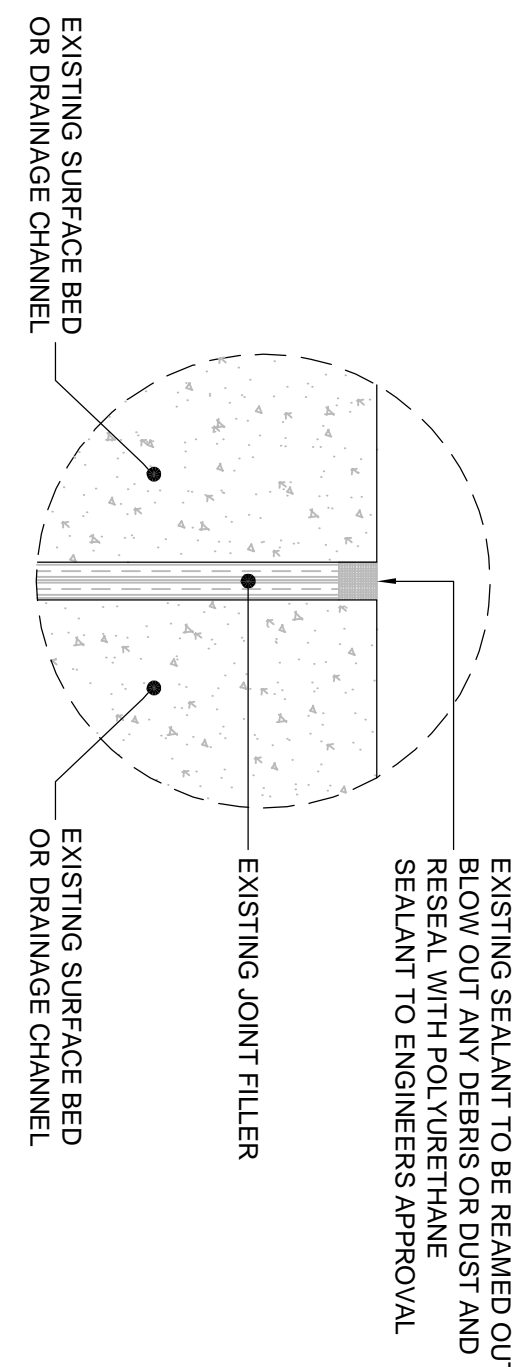

DETAIL D

SCALE 1:

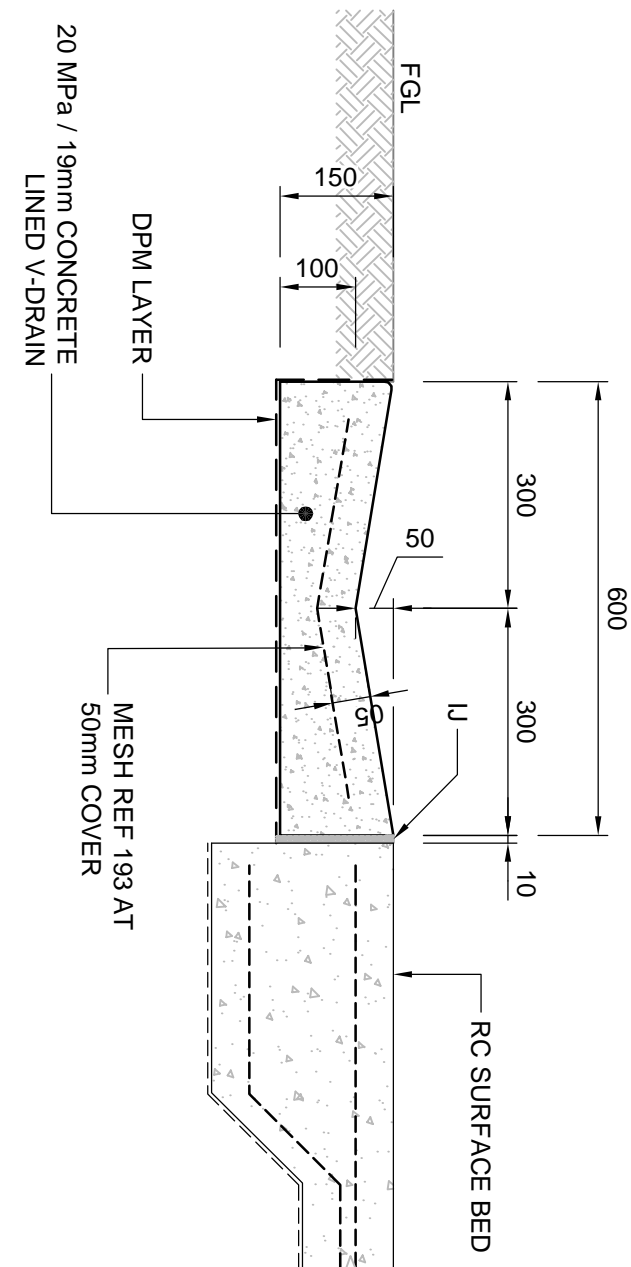

600 mm V-DRAIN DETAIL

SCALE 1:1

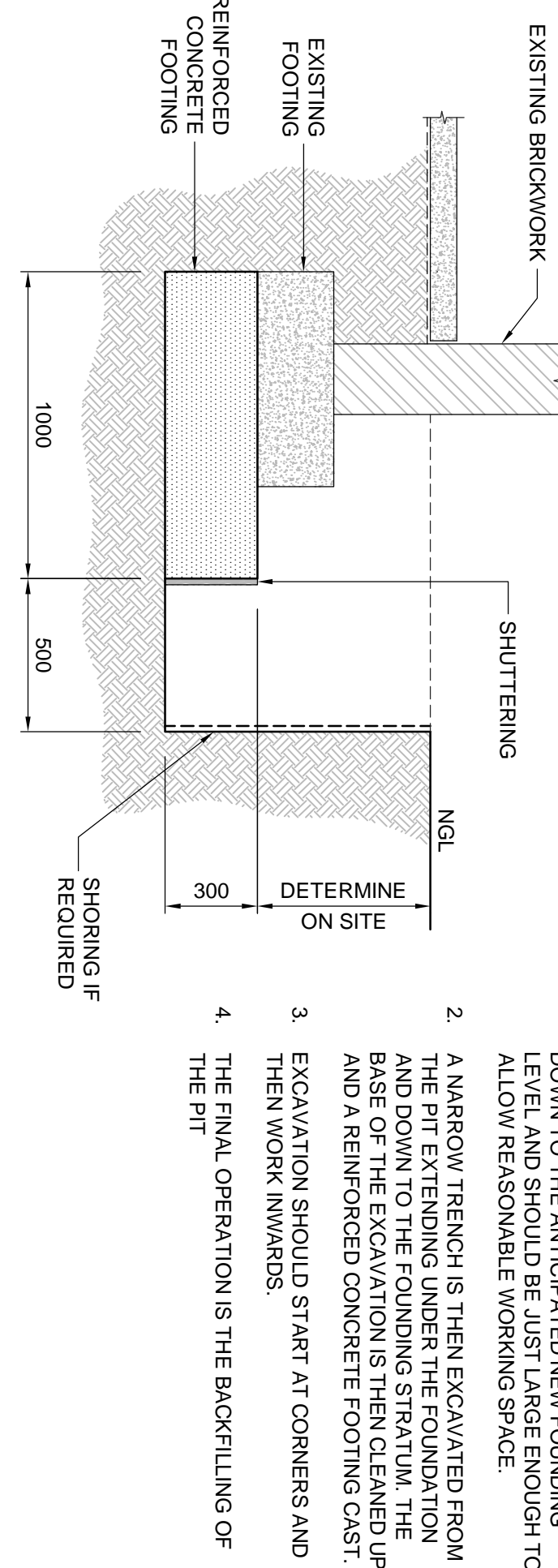

TYPICAL UNDERPINNING DETAIL

SCALE 1

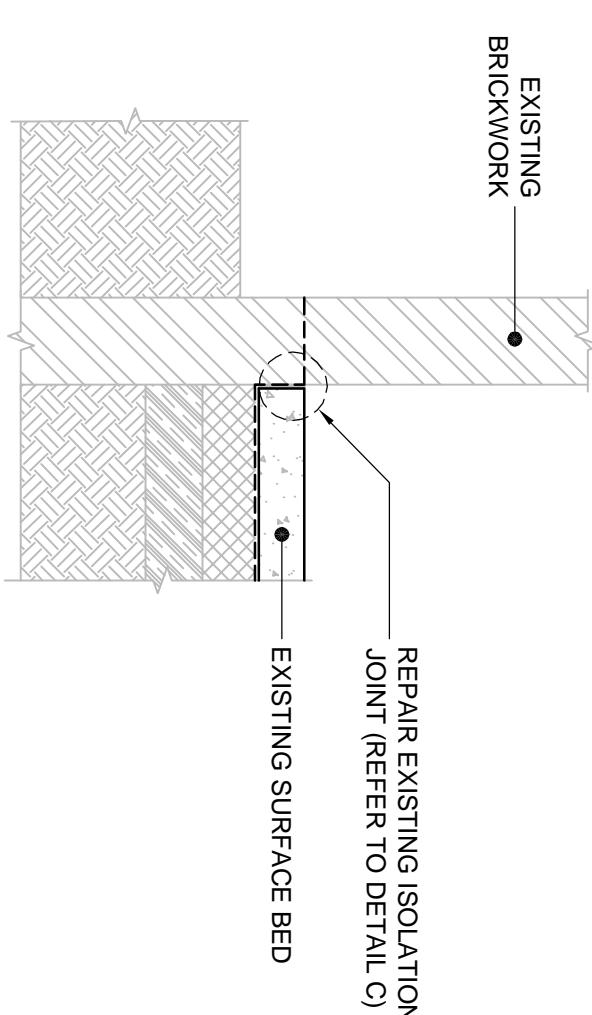

TYPICAL ISOLATION JOINT REPAIR DETAIL
SURFACE BED TO BRICKWORK

SCALE 1:20

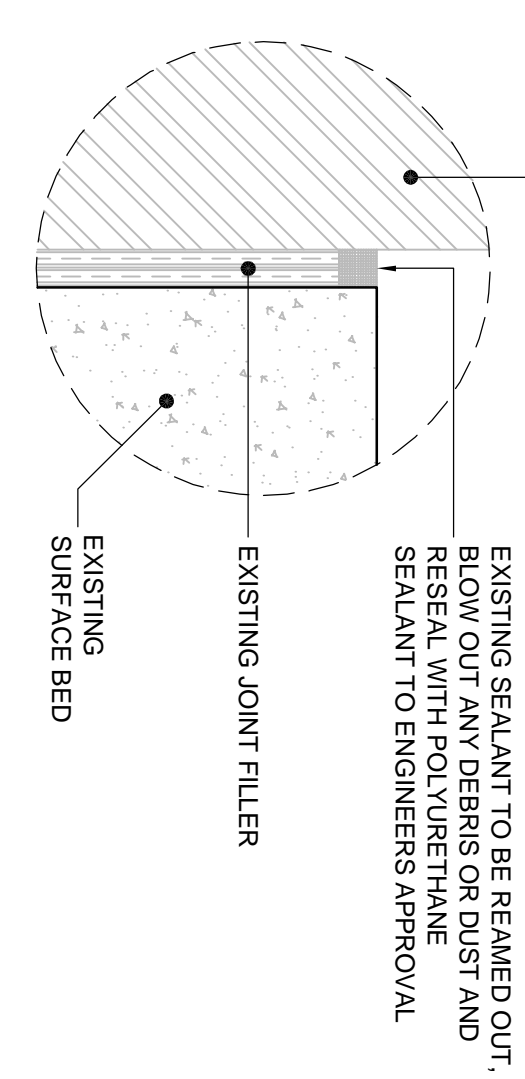

DETAIL C

SCALE 1:2

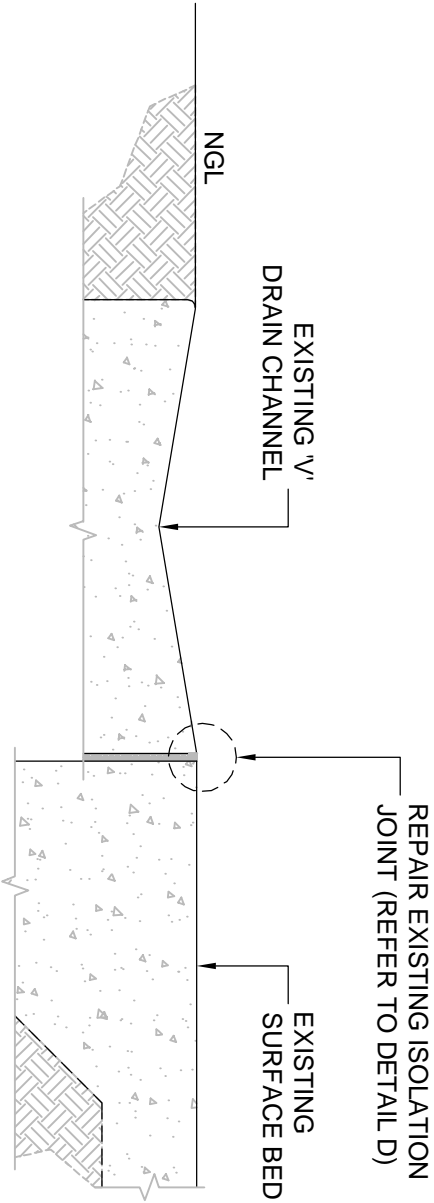

**TYPICAL ISOLATION JOINT REPAIR DETAIL
SURFACE BED TO DRAINAGE CHANNEL**

SCALE 1:10

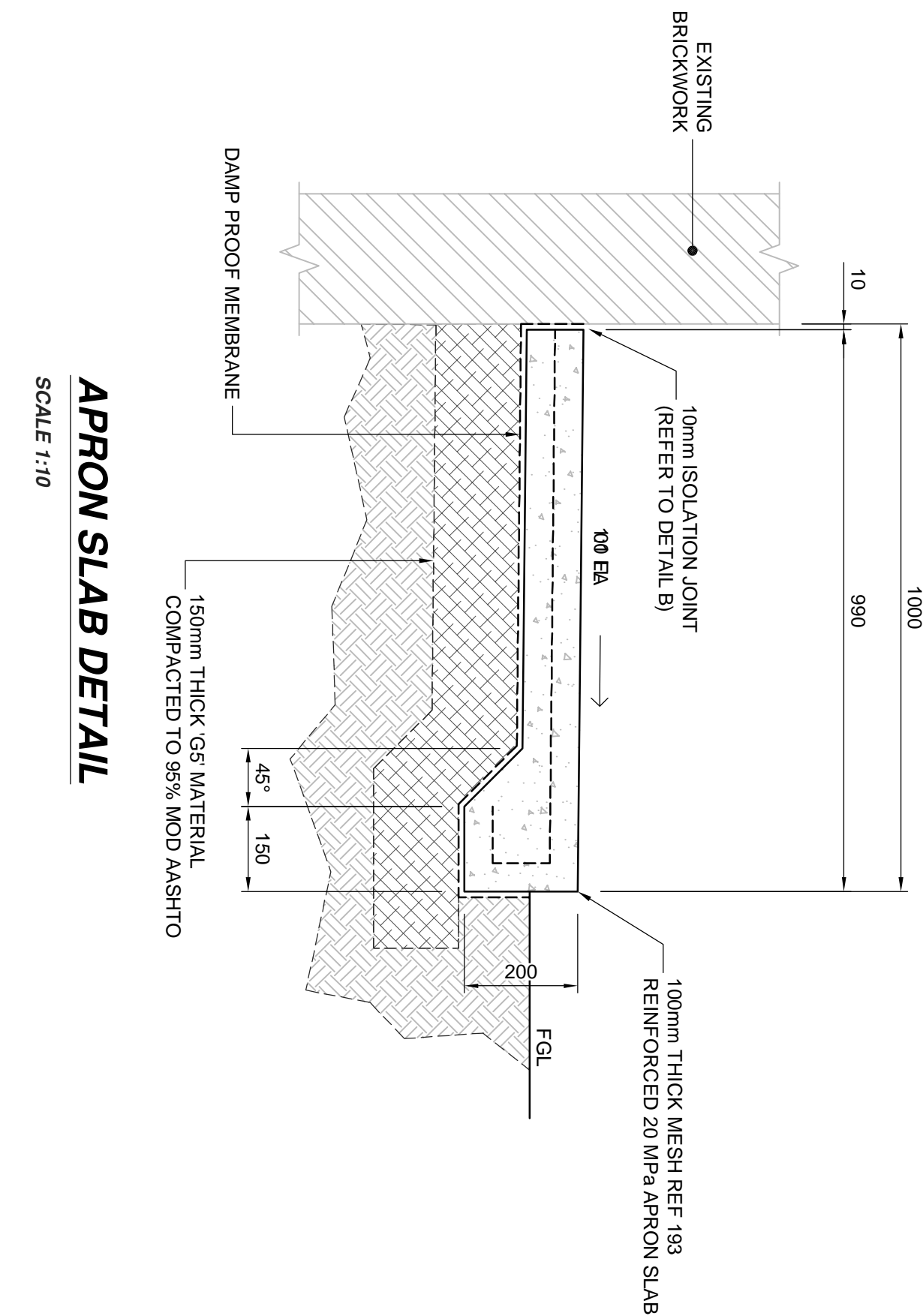

APRON SLAB DETAIL

SCALE 1:10

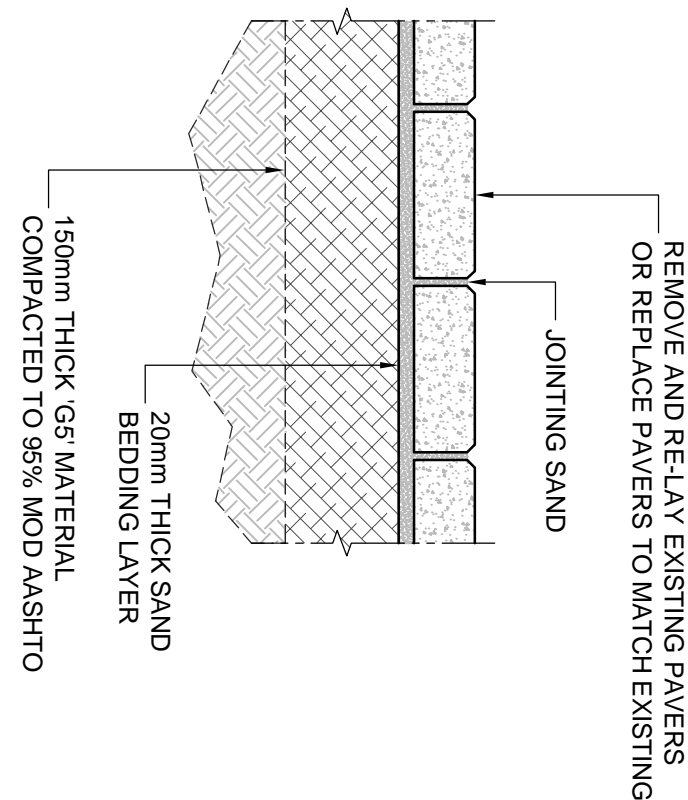

TYPICAL PAVING DETAIL

SCALE 1:10

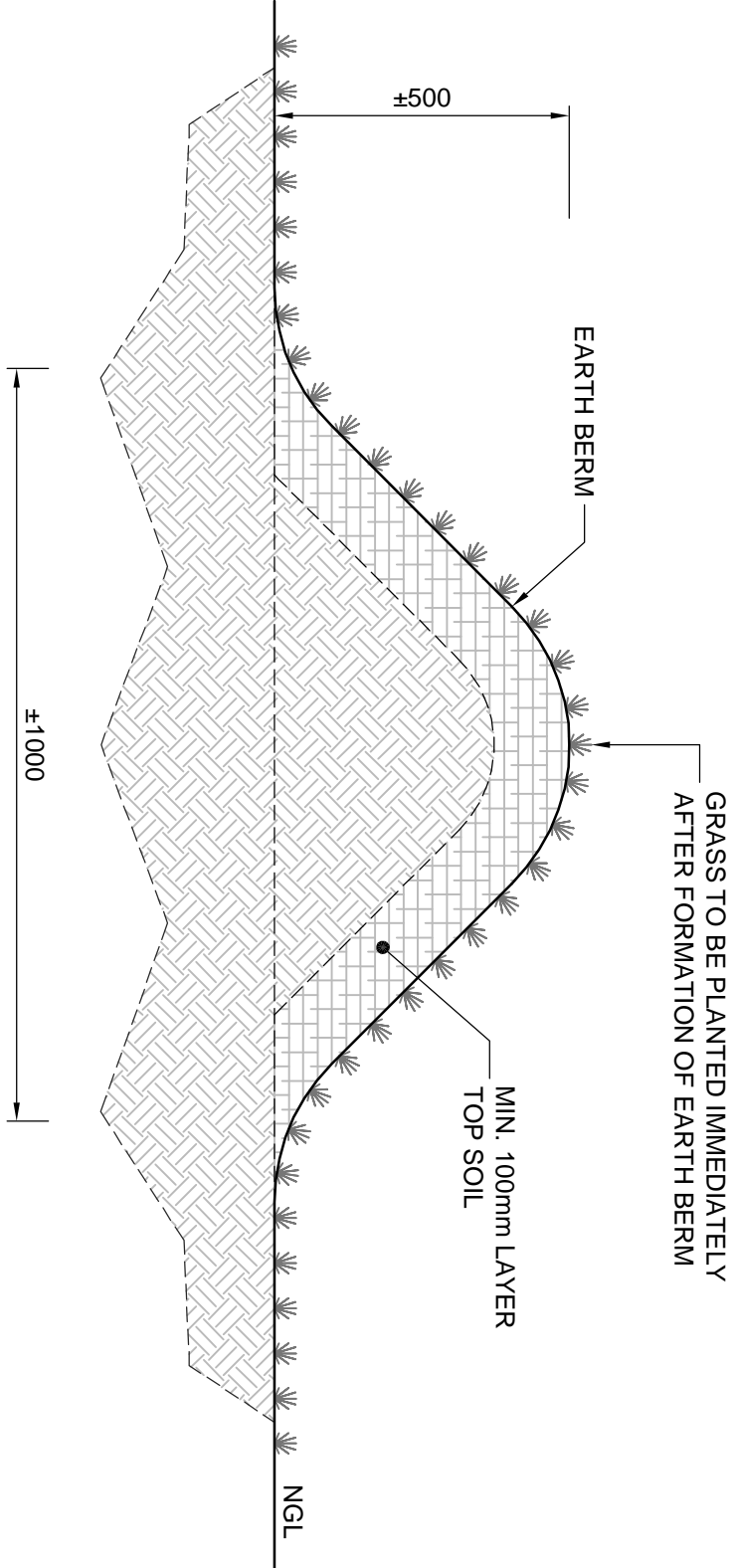

EARTH BERM DETAIL

SCALE 1:10